

## Application Methods-Wall

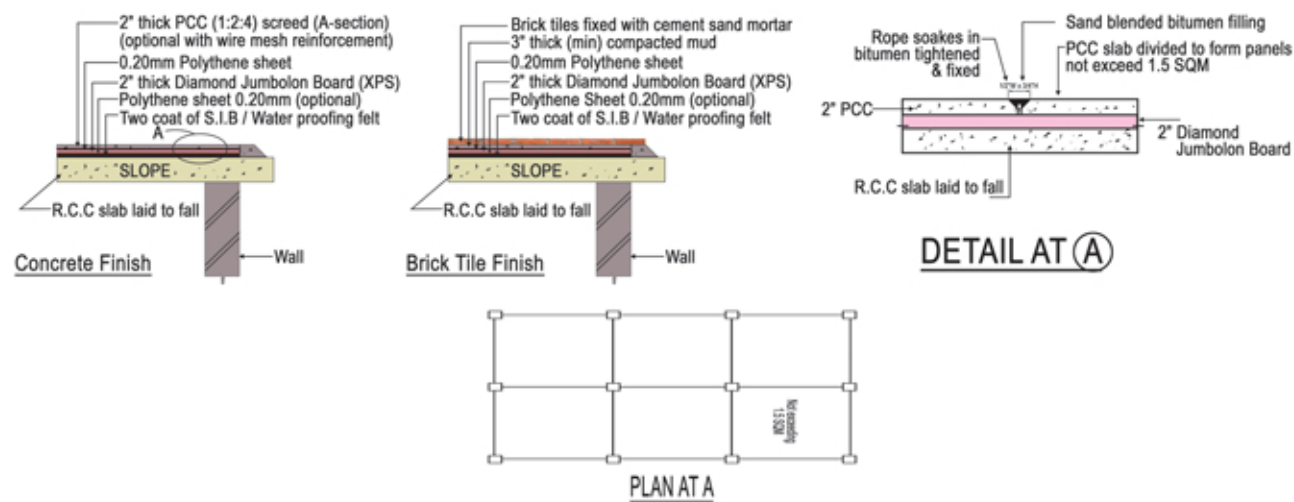

## Application Methods-Roof



## For a better Pakistan

We manufacture thermal insulation products according to international quality standards and our consumer's requirements, so that

- We can satisfy our customers
- Bring profitability to the company
- Save energy for the country



**DIAMOND**  
**Jumbolon-Board®**  
WORLD'S BEST INSULATION MATERIAL  
with unique sustainable properties

**INSULATE NOW**  
TO KEEP YOUR HOMES COOLER IN SUMMER  
AND WARMER IN WINTER

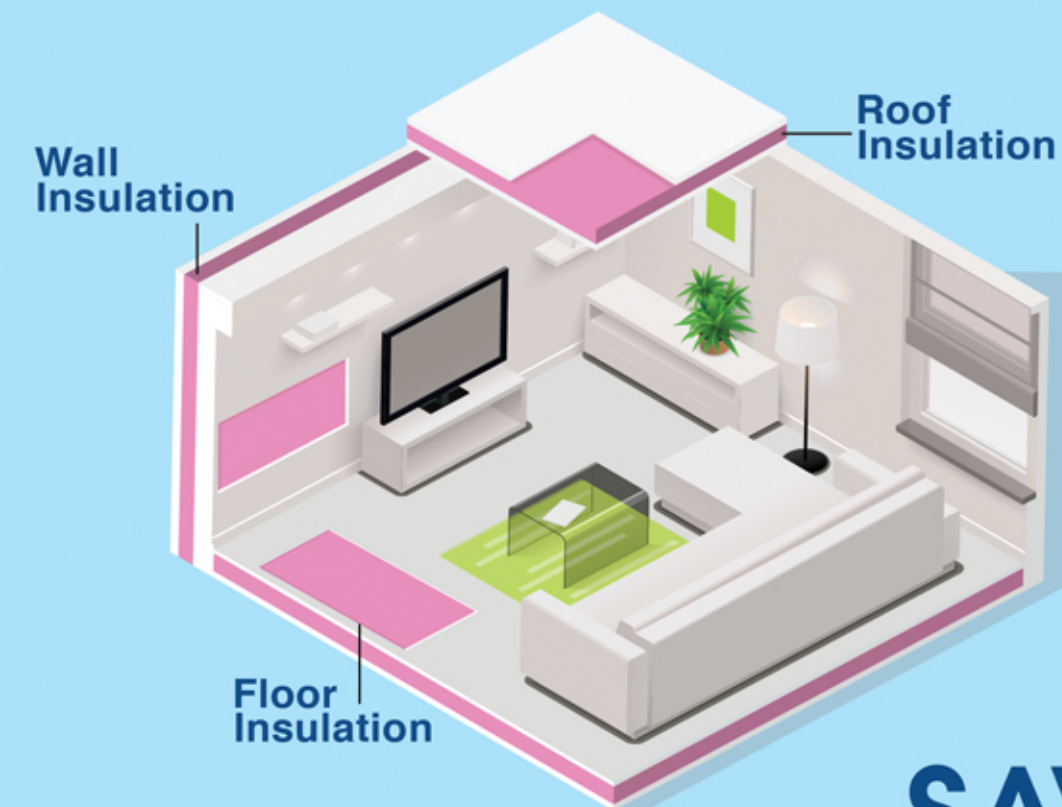

**SAVES**  
**35%** UPTO  
in utility bills  
& energy  
consumption





## Robust solution for a tough problem

### Exceptional Strength

- High resistance to settlement and compaction
- Dimensional and edge profile stability
- Proven long term performance

### Excellent Moisture Resistance (Closed-Cell Structure)

- Very high resistance to moisture penetration
- Low vapour permeability
- Proven long term retention of these Properties

### Superior Thermal Resistance

- Low thermal conductivity
- Thinner boards required compared to some traditional materials
- High resistance to freeze thaw cycles

### Health and Safety / Handling

- Non-toxic, non-pollutant
- Non-irritant, light weight and easy to handle

### Product Range

DIAMOND Jumbolon-Board is available in different compressive strengths and a range of thickness. Length: 1250 - 2500 mm Width: 600 - 900 mm Thickness: 20 - 100 mm

### EDGE PROFILE



Ship Lap

Tongue & Groove



## DESCRIPTION

Using top of the line state-of-the-art technology, makers of Diamond Supreme Foam have now introduced for the first time in Pakistan, DIAMOND Jumbolon-Board, being produced on fully automated extrusion process in accordance with international specifications and standards. This particular technology makes it possible to guarantee thoroughly closed-cell structure, excellent thermal resistant properties, resistance to the diffusion of water vapour, uniform density, distribution, exceptional mechanical properties, dimensional stability, very high compressive strength, aging resistance and immunity against insects, micro organisms, pests, bacteria and rodent attacks.

## USAGES

- Roof Insulation
- Cold Storage Insulation
- Control Shed Insulation
- Wall Insulation
- Water Tank Insulation
- Climate Control Rooms

## INSTALLATION TECHNIQUES

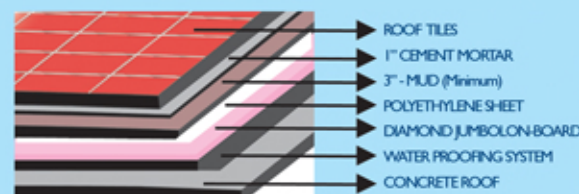

ROOF INSULATION Method - 1



ROOF INSULATION Method - 2

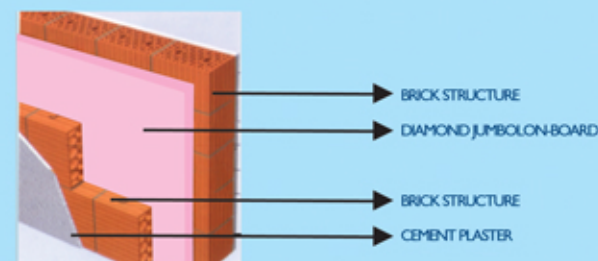

WALL INSULATION

## SALIENT FEATURES

- Using top of the line state-of-the-art technology.
- Produced first time in Pakistan.
- Thoroughly closed-cell structure.
- Long term high insulation efficiency.
- Excellent compressive strength.
- Uniform density distribution.
- Resistance to aging.
- Resistance to rotting.
- Good dimensional stability.
- High resistance to thermal cycle.

Updated on December 8<sup>th</sup>, 2020. Superseding all the previous data.

ITEM	UNIT	RESULT	TESTING METHOD
Color	—	Pink Optional: Green/Blue	—
Cell structure	—	Closed very fine	—
Available Densities *	kg/m <sup>3</sup>	32 ~ 35 ± 10%	ASTM-D1622
Thermal conductivity 25mm (thickness)	BTU in/ft <sup>2</sup> .hr.°F W/mk	0.1789 0.0258	ASTM C-518 KS M 3808-'05
R-Value 25mm (thickness)	ft <sup>2</sup> .hr.°F/BTU in m <sup>2</sup> k/W	5.589 0.9844	ASTM C-518 KS M 3808-'05
Compressive strength	kPa	250 ~ 350	ASTM D 1621
Coefficient of linear thermal expansion	mm/mk	0.07	BS4370: Method 13
Temperature limits	°C	-50/ + 75	—
Fire classification	LOI	B1 28-29.5	GB 8624 ASTMD: 2863
Water absorption by volume	%	≤ 0.3	ASTM C-272
Size: Length Width	mm mm	1250 - 2500 600 - 900	—
Thickness	mm	20 ~ 100 ± 5%	—
Edge profile	—	Butt Ship lap Tongue & groove	—
Surface	—	Smooth Shaved Grooved	—

\* Density can be produced on request 38 Kg / M<sup>3</sup> (Price varies)

## ENVIRONMENTAL POLICY

Our company policy is to manufacture thermal insulation products which help save energy, while at the same time, not causing any kind of environmental pollution. DAMOND Jumbolon-Board is: Non toxic, Non Pollutant, Non irritant and clean.

## ETHICS

We at DIAMOND JUMBOLON understand customers' needs, lead in quality, supported by a cost efficient product line through our efficient manufacturing operations and spirit to deliver.

## STORAGE

DIAMOND Jumbolon-Board extruded polystyrene products should be stored under a shed on a clean, flat surface in an area free from flammable or volatile materials.

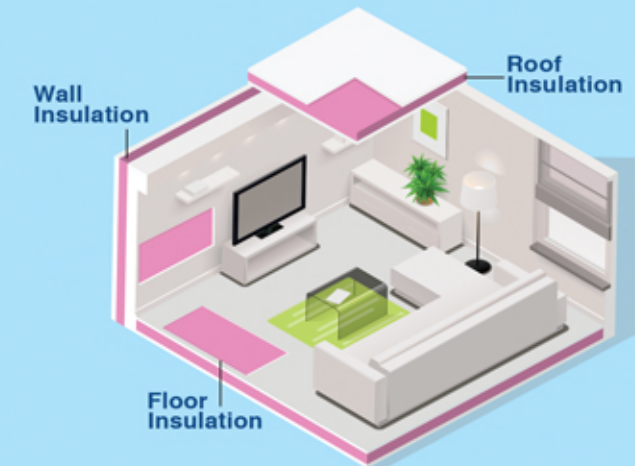

**SAVES**  
**35%** UPTO  
in utility bills  
& energy  
consumption